

TECHNICAL
SPECIFICATION



STRESSOR ELECTRIC POWER PACK



Permaquip Ltd

Old Sleningford Farm,
North Stainley,
Ripon,
North Yorkshire, HG4 3JB

Tel: +44 (0) 1623 513349

E-mail: sales@permaquip.co.uk
www.permaquip.co.uk



Description:

The *New* Permaquip™ Electric Power Pack is designed to be used in conjunction with the Permaquip™ stressor adjust the gap between rail ends for rail stressing, rail welding, repairing rail failures, and for installing insulated joints.

Based on the Permaquip Stressor Petrol Power Pack, the new Electric DC model utilises the same pump configuration with added benefit of the zero-carbon emission engine. With reduced HAV and operating decibel levels and a constant operating (running) time exceeding 35mins.

The Permaquip™ Electric Power Pack can be handled using the lifting / carrying tongs for reduced manual handling effort.

The Permaquip™ Electric Power Pack is designed to be used in conjunction with the Permaquip Stressor.

The Power pack is predominantly powder-coated yellow for high visibility when on track.

Please note:

All information, illustrations and specifications in this Technical Sheet are based on the latest information available at the time of publication. The right is reserved to make changes at any time without notice.

Equipment operators and installers shall be responsible for ensuring that a safe working environment and safe systems of work are in place and in certain circumstances advice and permission from the controlling authority must be sought before any operation, installation or surveying work is carried out.

Permaquip™ is a trademark of Permaquip Ltd.

©2006 Permaquip Ltd.

Electric Power Pack Layout:

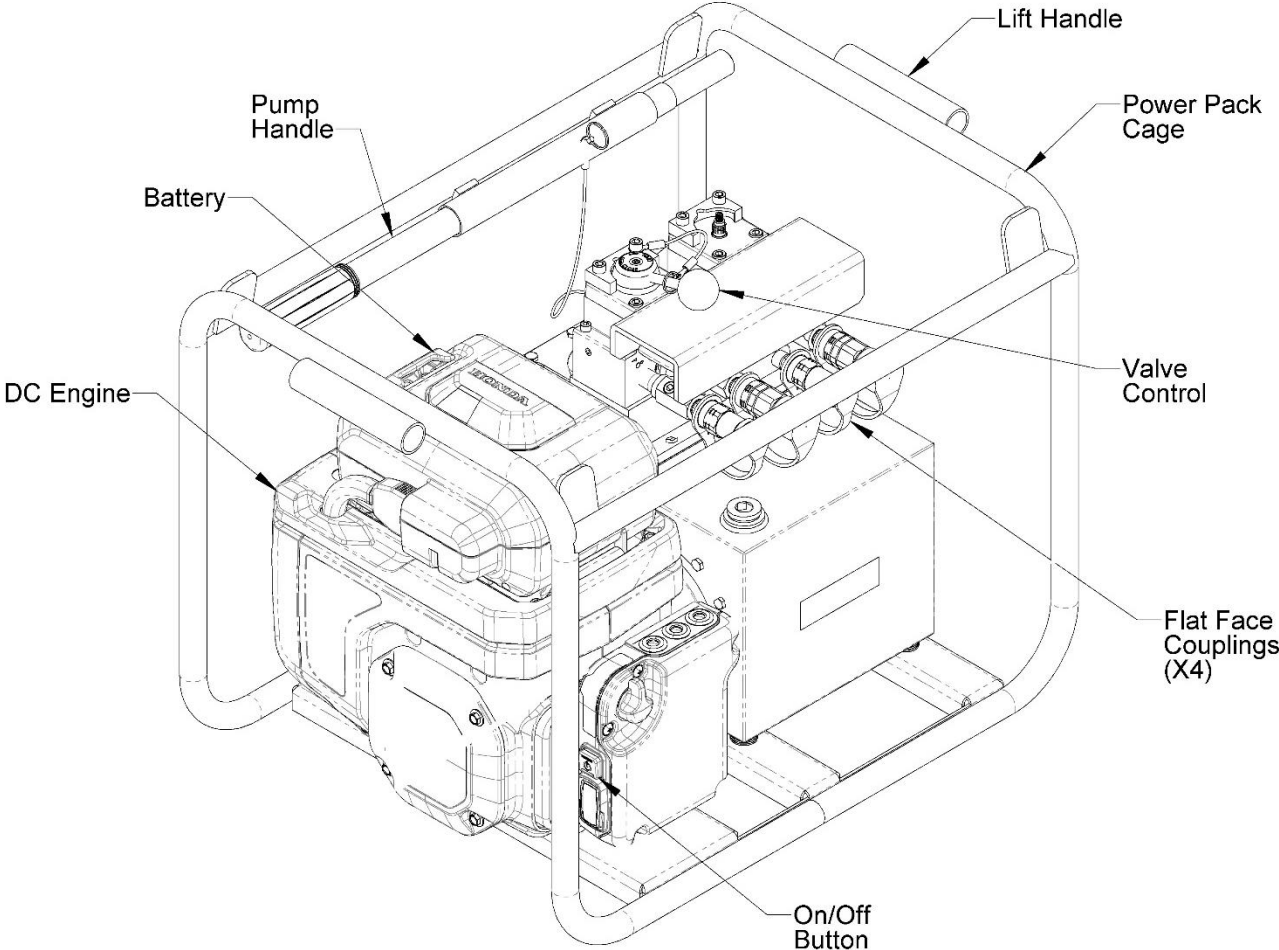

Technical Data:

Stressor Power Pack Numbers:

- Stressor Electric Power Pack FFC 38848
- Honda DC Battery 040707348
- Honda DC Battery Charger 040707349
- Hose Assembly FFC 33281
- Stressor Lifting/Carrying Tongs 38854

Overall dimensions:

- Length 736mm
- Width 508mm
- Height 540mm

Operating Pressures & Performance:

- Closed Flow 8,400 PSI (57.9MNm-2)
Internal Pressure Relief Valve Set at 8400 PSI to prevent over-pressure conditions.
- Open Flow 2,800 PSI (19.4 MNm-2)

Permaquip Electric Power Pack - FCC

